

**THE CORPORATION OF THE
TOWNSHIP OF EDWARDSBURGH CARDINAL
BY-LAW NO. 2021-74**

“BEING A BY-LAW TO AMEND ZONING BY-LAW NO. 2012-35, AS AMENDED”

**J. Douglas Grenkie o/b Gerrit Zwarts, Eibertje Stinson
& J.F Dobbie & Sons Limited
Part of Lot 6 & 7, Concession 7
7131 County Road 22**

WHEREAS By-law No. 2012-35 as amended regulates the use of land and the use and erection of buildings and structures within the Township of Edwardsburgh Cardinal;

AND WHEREAS the Council of the Corporation of the Township of Edwardsburgh Cardinal deems it advisable to amend By-law No. 2012-35 as hereinafter set forth;

NOW THEREFORE the Council of the Corporation of the Township of Edwardsburgh Cardinal enacts as follows:

1. The lands affected by this By-law are shown as shaded and outlined by heavy black lines on Schedule “A” which is attached hereto and forms part of this By-law.
2. Zoning By-law No. 2012-35, as amended, is hereby further amended by adding the following new subsection at the end of Section 10.2 (d) (Exception Zones):

[xiii] A-13, Part of Lot 6 & 7, Concession 7

Despite provisions of 10.2(a) to the contrary, on lands zoned A-13, the following uses shall not be permitted:

**Dwelling, Accessory
Dwelling, Single Detached**

Despite provisions of 10.2(b) to the contrary, on lands zoned A-13, the minimum lot area shall be 30 ha.

3. Schedule “A” to Zoning By-law No. 2012-35, as amended, is hereby further amended by changing the zoning of the lands affected by this By-law from “A” to “A-13”.
4. The By-law shall become effective on the date of passing hereof, subject to the provisions of Section 34 (21) of the *Planning Act*, R.S.O. 1990, as amended.

Read a first and second time this in open Council this 13 day of December, 2021.

Read a third and final time, passed, signed and sealed in open Council this 13 day of December, 2021.

Mayor

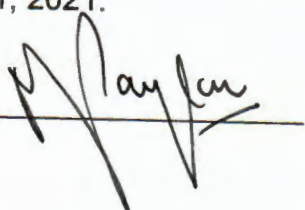

Clerk



Schedule "A" to By-law No. 2021-74

TOWNSHIP OF EDWARDSBURGH CARDINAL

Part of Lot 6 & 7, Concession 7

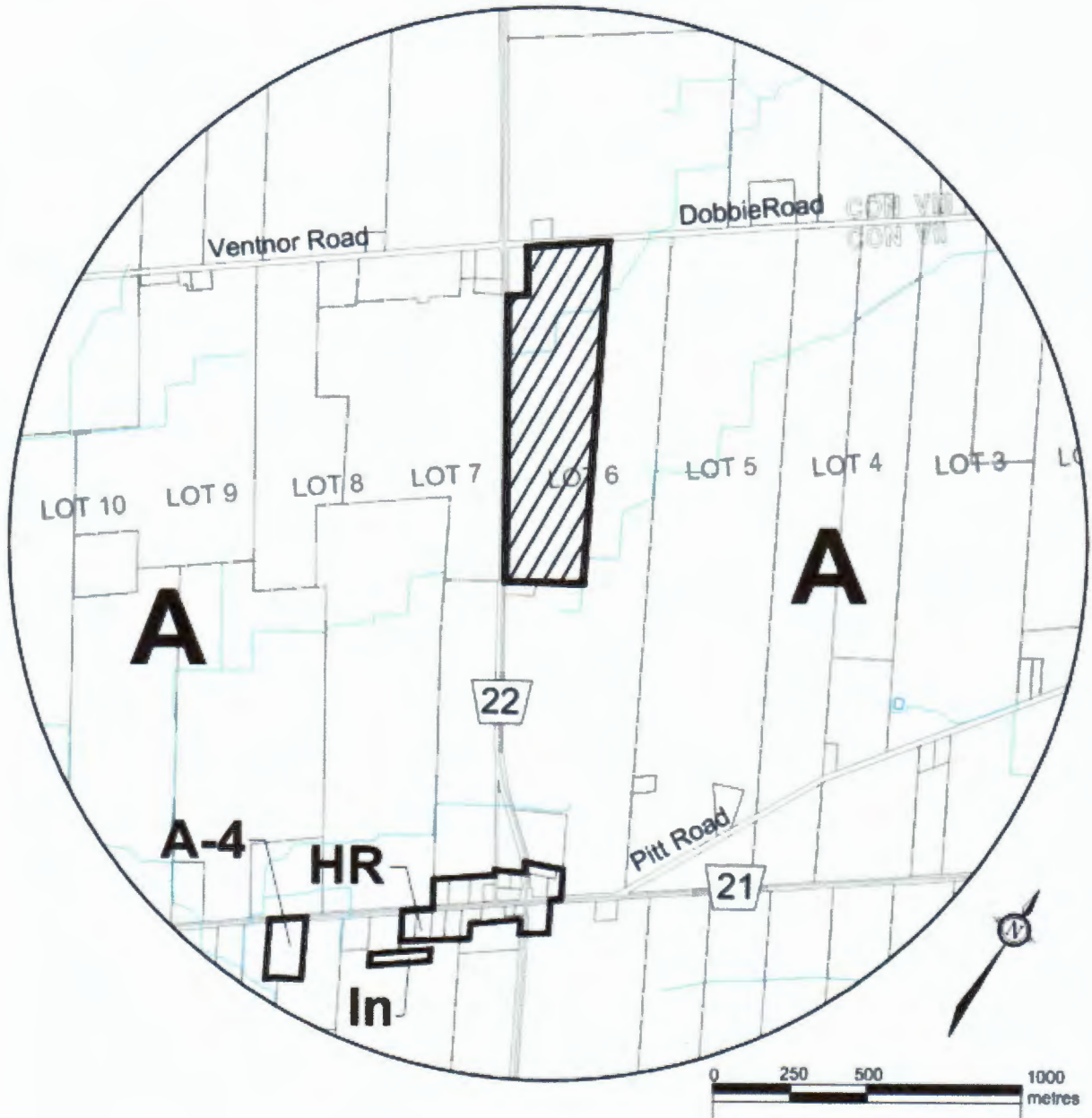

AREA(S) SUBJECT TO THIS BY-LAW



TO: AGRICULTURAL SPECIAL
EXCEPTION 13 (A-13) ZONE

FROM: AGRICULTURAL (A) ZONE