

KEYPLAN (NTS)

PITTSTON - GARAGE

GRIT OIL SEPARATOR REPLACEMENT

4145 County Rd 22.
Spencerville ON K0E 1X0

CLIENT No.: XXXX

CIVIL - LIST OF DRAWINGS

C-0 COVER
C-1 REMOVALS
C-2 SITE PLAN
C-3 DETAILS

2	2025-04-29	KH	ISSUED FOR TENDER
1	2025-03-19		ISSUED FOR REVIEW
No.	YYYY-MM-DD	BY	DESCRIPTION



640 CATARAQUI WOODS DR, UNIT 2A, KINGSTON, ON, K7P 2Y5
T: 613-538-5420
KINGSTON@JP2G.COM

Jp2g PROJECT No.: 24-5-5470

SHEET #

C-0

JWG NAME: J:\5-CIVIL\2025\25-5048A - EDWARDSBUGH CARDINAL - PITTSTON GARAGE (TNP.EC) - COPY\DRAWINGS\WORKING\2455470-PITTSTON GARAGE.CURRENT - 4-25-2025.DWG LAYOUT: C-0 SAVED ON 2025-04-29

DWG NAME: 16-CIVIL-02025-0434 - EDWARDSBURGH, CARDINAL - PITSTON GARAGE (TYP. E.C.) - COPY OF DRAWINGS WORKING 2454470-PITSTON GARAGE CURRENT - 4-25-2025.DWG LAYOUT: C1 - BASED ON 2025-04-29

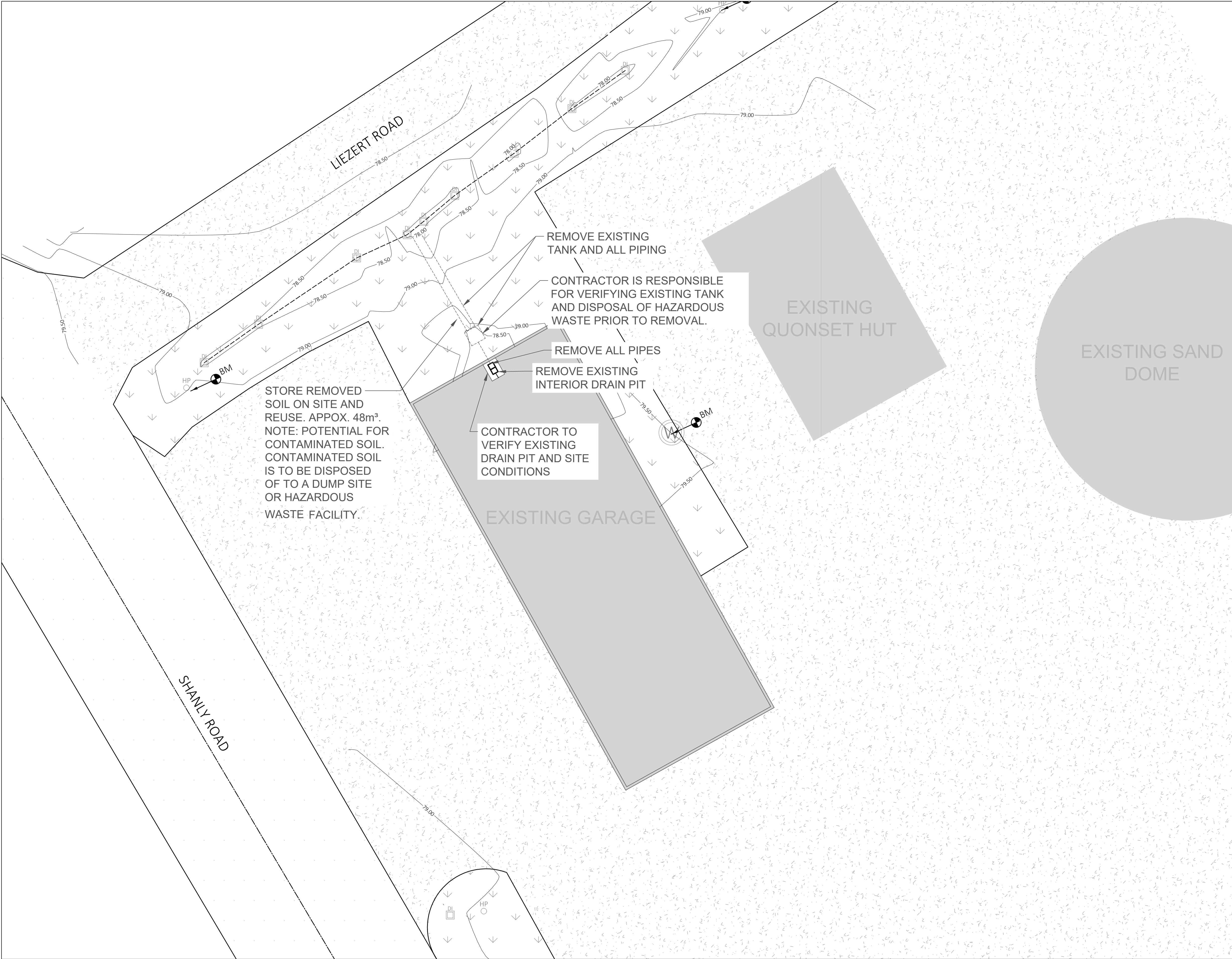

PARTIAL SITE PLAN
SCALE 1:150

CLIENT LOGO

KEYPLAN (NTS)



DISCLAIMER NOTES

1. THE CONTRACTOR SHALL BE SOLELY RESPONSIBLE FOR ISSUES/PROBLEMS WHICH MAY OCCUR AS A RESULT OF A FAILURE TO FOLLOW THESE PLANS, SPECIFICATIONS AND THE DESIGN INTENT THEY CONVEY.
2. WHERE THERE ARE ALLEGED ERRORS, OMISSIONS, INCONSISTENCIES OR AMBIGUITIES PRESENT IN THE CONTRACT DOCUMENTS, THE CONTRACTOR MUST SEEK CLARIFICATION FROM JP2G. ANY COSTS OR SCHEDULE DELAYS WHICH RESULT AS A FAILURE TO CONTACT JP2G FOR DIRECTION SHALL BE SOLELY THE RESPONSIBILITY OF THE CONTRACTOR.
3. DO NOT SCALE DRAWINGS. REFER ANY DIMENSIONAL CLARIFICATIONS AND/OR POSSIBLE TRADE INTERFERENCE/CONFLICTS TO JP2G FOR CLARIFICATION PRIOR TO COMMENCEMENT OF THE WORK.
4. THE CONTRACTOR SHALL BE RESPONSIBLE FOR ALL COORDINATION WITH SUBTRADES AND SHALL ADDRESS CONSTRUCTION TEAM COORDINATION ITEMS PRIOR TO ISSUING REQUESTS FOR INFORMATION FROM JP2G.
5. THE POSITION OF POLE LINES, CONDUITS, WATERMANS, SEWERS AND OTHER UNDERGROUND AND OVERGROUND UTILITIES AND STRUCTURES IS NOT NECESSARILY SHOWN ON THE CONTRACT DRAWING, AND, WHERE SHOWN, THE ACCURACY OF THE POSITION OF SUCH UTILITIES AND STRUCTURES IS NOT GUARANTEED. BEFORE STARTING WORK, THE CONTRACTOR SHALL INFORM THEMSELVES OF THE EXACT LOCATION OF ALL SUCH UTILITIES AND STRUCTURES, AND SHALL ASSUME ALL LIABILITY FOR DAMAGE TO THEM.

NOT FOR
CONSTRUCTION

1 2025-04-29 KH ISSUED FOR TENDER

No. YYYY-MM-DD BY DESCRIPTION

STAMP



PROJECT

PITSTON - GARAGE
OIL GRIT SEPARATOR
REPLACEMENT

4145 County Rd 22
Spencerville ON K0E 1X0

DRAWING

REMOVALS

GREER GALLOWAY
a division of Jp2g Consultants Inc.

640 CATARAUGUI WOODS DR, UNIT 2A, KINGSTON, ON, K7P 2Y5
T: 613-535-5420
KINGSTON@JP2G.COM

Jp2g PROJECT No.: 2455470

NORTH

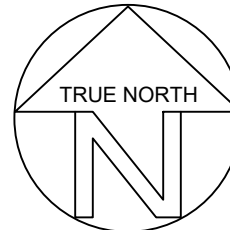

CLIENT No.: XXXX

DRAFTED: M. ROWSELL

DESIGNED: A. HICKS

REVIEWED: K. HAWLEY

APPROVED: K. HAWLEY

SCALE

1:250
0 m 2 4 6 10 m

H= 1:250

V= 1:50

SHEET #

C-1

DWG NAME: 16-CIVIL-020205-0404 - EDWARDSBURGH, CARDINAL - PITSTON GARAGE (TYP. E.C.) - COPY FOR WORKING DRAWINGS 04/04/2025 - PITSTON GARAGE CURRENT - 4-25-2025.DWG LAYOUT: C2 BASED ON 2025-04-29

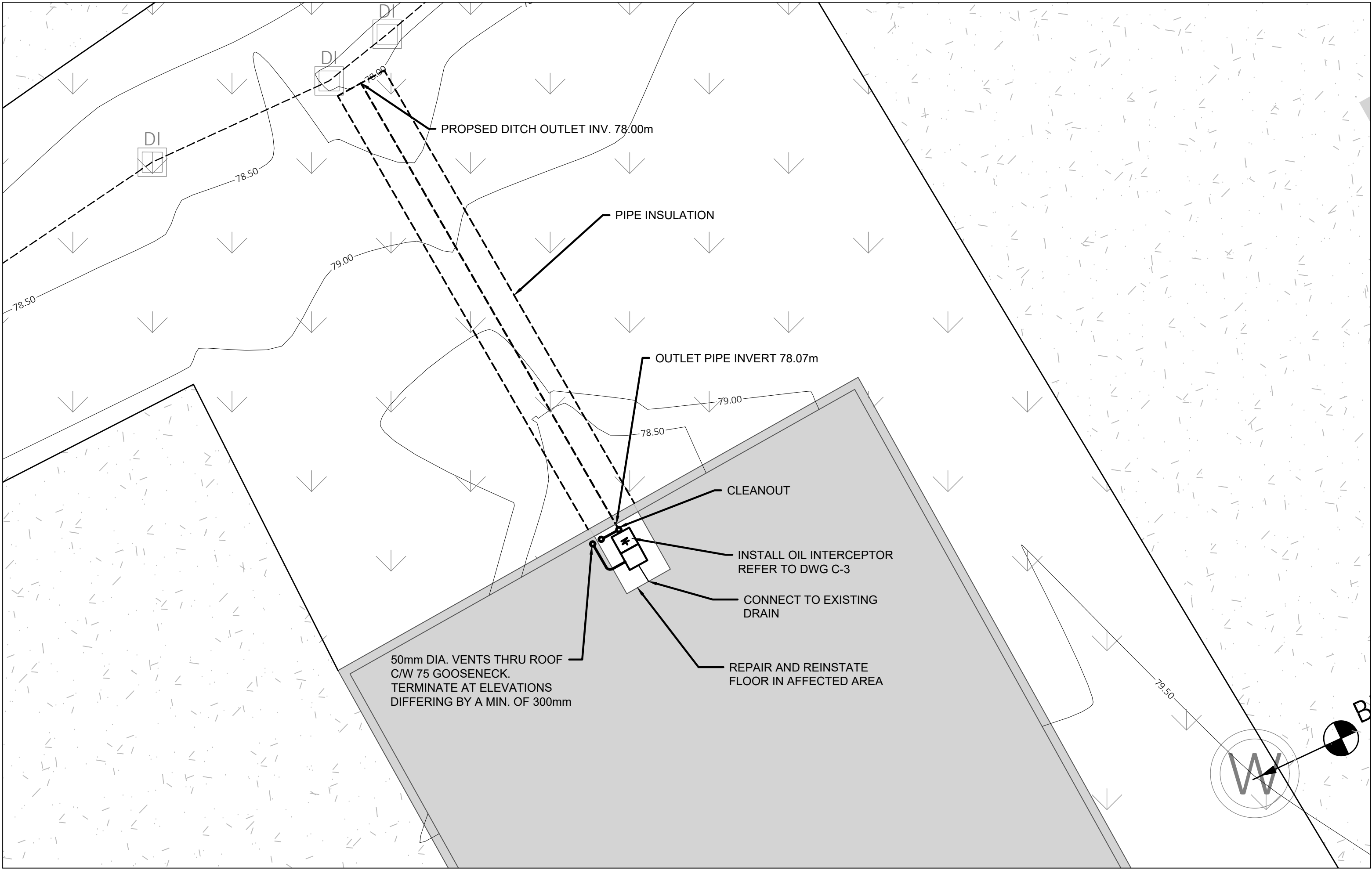

PARTIAL SITE PLAN
SCALE 1:75

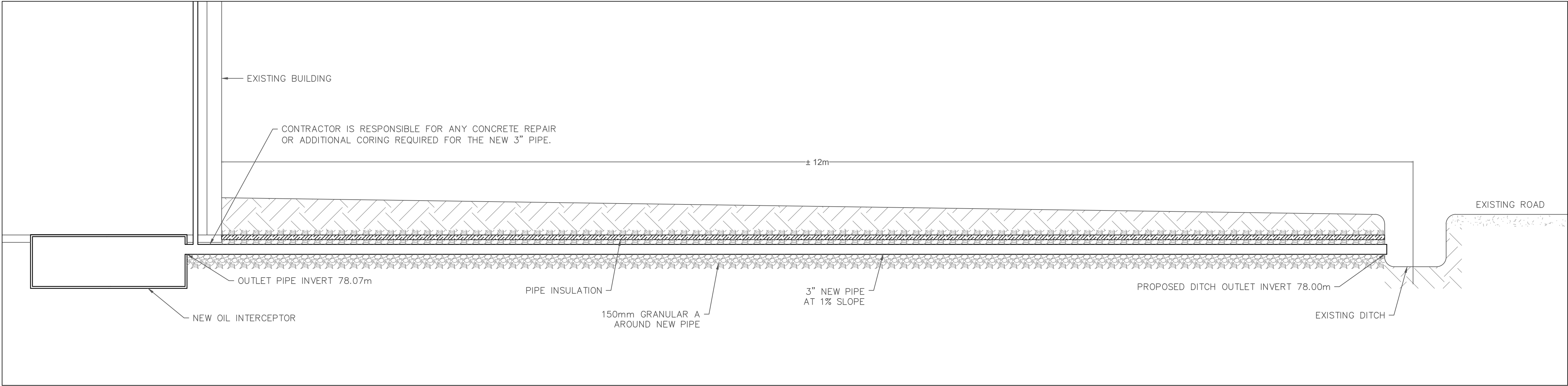

PARTIAL PROFILE PLAN
SCALE 1:25

CLIENT LOGO

KEYPLAN (NTS)

DISCLAIMER NOTES

1. THE CONTRACTOR SHALL BE SOLELY RESPONSIBLE FOR ISSUES/PROBLEMS WHICH MAY OCCUR AS A RESULT OF A FAILURE TO FOLLOW THESE PLANS, SPECIFICATIONS AND THE DESIGN INTENT THEY CONVEY.

2. WHERE THERE ARE ALLEGED ERRORS, OMISSIONS, INCONSISTENCIES OR AMBIGUITIES PRESENT IN THE CONTRACT DOCUMENTS, THE CONTRACTOR MUST SEEK CLARIFICATION FROM JP2G. ANY COSTS OR SCHEDULE DELAYS WHICH RESULT AS A FAILURE TO CONTACT JP2G FOR DIRECTION SHALL BE SOLELY THE RESPONSIBILITY OF THE CONTRACTOR.

3. DO NOT SCALE DRAWINGS. REFER ANY DIMENSIONAL CLARIFICATIONS AND/OR POSSIBLE TRADE INTERFERENCE/CONFLICTS TO JP2G FOR CLARIFICATION PRIOR TO COMMENCEMENT OF THE WORK.

4. THE CONTRACTOR SHALL BE RESPONSIBLE FOR ALL COORDINATION WITH SUBTRADES AND SHALL ADDRESS CONSTRUCTION TEAM COORDINATION ITEMS PRIOR TO ISSUING REQUESTS FOR INFORMATION FROM JP2G.

5. THE POSITION OF POLE LINES, CONDUITS, WATERMANS, SEWERS AND OTHER UNDERGROUND AND OVERGROUND UTILITIES AND STRUCTURES IS NOT NECESSARILY SHOWN ON THE CONTRACT DRAWING, AND, WHERE SHOWN, THE ACCURACY OF THE POSITION OF SUCH UTILITIES AND STRUCTURES IS NOT GUARANTEED. BEFORE STARTING WORK, THE CONTRACTOR SHALL INFORM THEMSELVES OF THE EXACT LOCATION OF ALL SUCH UTILITIES AND STRUCTURES, AND SHALL ASSUME ALL LIABILITY FOR DAMAGE TO THEM.

NOT FOR
CONSTRUCTION

1	2025-04-29	KH	ISSUED FOR TENDER
No.	YYYY-MM-DD	BY	DESCRIPTION
STAMP	<div></div>		
STAMP			

PROJECT

PITSTON - GARAGE
OIL GRIT SEPARATOR
REPLACEMENT

4145 County Rd 22
Spencerville ON K0E 1X0

DRAWING

SITEPLAN
AND PROFILE

 **GREER GALLOWAY**
a division of Jp2g Consultants Inc.

640 CATARAUGUI WOODS DR, UNIT 2A, KINGSTON, ON, K7P 2Y5
T: 613-536-5420
KINGSTON@JP2G.COM

Jp2g PROJECT No.: 2455470

NORTH

SCALE

0 m 2 4 6 8 10 m

CLIENT No.: XXXX

DRAFTED: M. ROWSELL

DESIGNED: A. HICKS

REVIEWED: K. HAWLEY

APPROVED: K. HAWLEY

SHEET #

H= 1:250
V= 1:50

C-2

GENERAL

1. All works to be installed in accordance with current Township of Edwardsburgh Cardinal Guidelines, Ontario Building Code and, Ontario Provincial Standard Specifications and Drawings unless specified otherwise.
2. Prior to construction, Contractor to verify all dimensions, sewer inverts and utility locates and identify possible conflicts. Contractor to report any discrepancy to the consultant before proceeding with the work.
3. All environmental protection measures are the responsibility of the contractor.
4. The location of utilities is approximate only, and the exact location should be determined by consulting the municipal authorities and utility companies concerned. The contractor shall prove the location of utilities and shall be responsible for adequate protection from damage during construction.

GRADING

1. Finished surfaces shall match existing. If disturbed, finished surfaces to be at a minimum grade of 2% unless otherwise noted.
2. Slopes in landscaped areas shall not exceed 3:1.
3. All existing elevations and grades are to be verified by the contractor prior to grading.
4. Utilities are to be located prior to construction.
5. All ground surfaces shall be graded to prevent ponding and without low areas except where approved swale or catchbasin outlets are provided.
6. The contractor is responsible for reviewing proposed grades with conflicts regarding the proposed structures.
7. Sub-grade shall be graded at a minimum of 3%, until a lower ditch is encountered an existing surface that has postive drainage away from the roadway.

SITE WORKS

1. 150 mm Granular A to be installed around pipe work. Compaction to be 98% SPMDD.
2. All disturbed areas to be remediated with 100 mm topsoil and seed as per OPSS 802 & OPSS 804.

CONCRETE

1. Use exposure class C-2 minimum 32 MPa at 28 days concrete for floor slab repair around new oil interceptor installation. Maximum water to cement ratio 0.45, 20M aggregate with 5-8% entrained air.
2. Concrete materials and methods of construction to conform to CSA A23.1.
3. Concrete testing to conform to CSA A23.2.

SEDIMENT AND EROSION CONTROL NOTES

1. Use straw bails in ditch as temporary sediment and erosion control during construction.
2. Any soil stockpiles shall be covered for erosion control and contained for sedimentation control during the course of the work.
3. All erosion and sediment controls shall be installed prior to construction and monitored and maintained by the Contractor throughout the construction process, until all disturbed areas have been re-vegetated then the temporary sediment and erosion control measures must be removed once the site has been stabilized/completed of site works.
4. All erosion and sediment control measures shall be inspected after prior to and after each rainfall to the satisfaction of the Contract Administrator.
5. Any disturbed areas not scheduled for further construction within forty-five (45) days will be provided with a suitable temporary mulch and seed cover within seven (7) days of completion. Regardless of site specific items detailed on the plans, the Contractor shall install erosion control measures to suit the proposed work methods to control sediment from running off the site prior to any disturbance.
7. Following construction, disturbed areas, as well as proposed grassed and vegetated surfaces, shall be reinstated as soon as practical.
8. All roads used to access the site shall be kept clean to the satisfaction of the Director of Public Works.

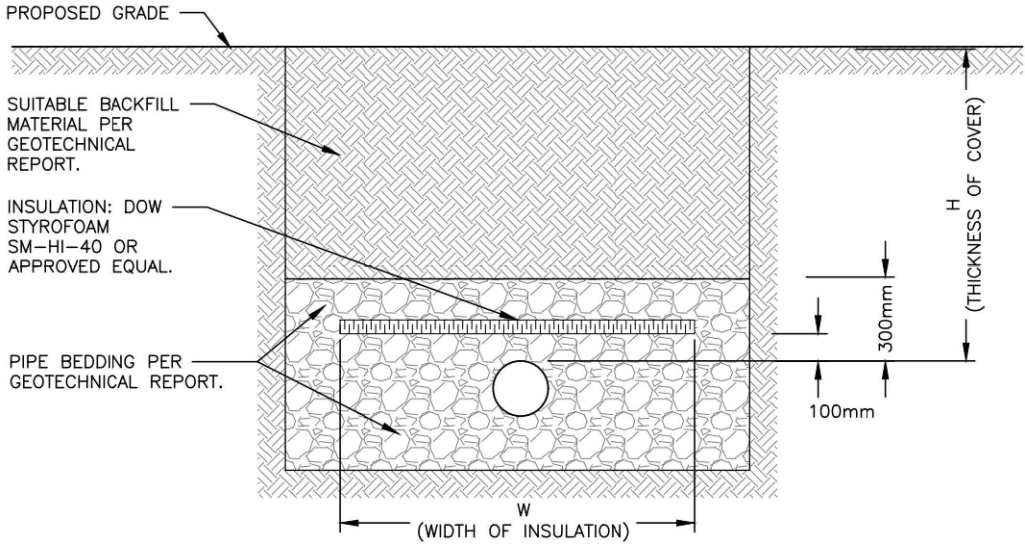

H (DEPTH OF COVER)	INSULATION THICKNESS	W (WIDTH OF INSULATION)
1500 TO 1800mm	50mm	1200mm + DIAMETER OF PIPE
1200 TO 1500mm	75mm	1800mm + DIAMETER OF PIPE
900 TO 1200mm	100mm	2400mm + DIAMETER OF PIPE

NO PIPE SERVICES SHALL BE BURIED LESS THAN 900MM BELOW PROPOSED FINISHED GRADE. ANY INSTALLATION OF PIPE INSULATION SHALL BE IN CONFORMANCE WITH APPENDIX A-7.3.5.4.(1) OF THE OBC UNLESS OTHERWISE SPECIFIED BY ENGINEER.

INSULATION OF PIPES IN SHALLOW TRENCHES TYP.
SCALE: NTS

OIL INTERCEPTOR SPECIFICATION:

1. STRIEM HIGH EFFICIENCY OIL/WATER SEPARATOR MODEL OS-25 OR APPROVED EQUAL. SEPARATOR SHALL BE CONSTRUCTED OF POLYETHYLENE. SEPARATOR SHALL BE MANUFACTURED FOR BELOW-GRADE INSTALLATION. FIELD ADJUSTABLE RISER SYSTEM IS REQUIRED TO BRING MANHOLE COVER TO GRADE. SEPARATOR FLOW RATE SHALL BE 25 GPM. SEPARATOR LIQUID HOLDING CAPACITY SHALL BE 21 GALLONS AND OIL CAPACITY SHALL BE 5.25 GALLONS. SOLIDS CAPACITY SHALL BE 6 GALLONS. PICKABLE CAST IRON COVER SHALL PROVIDE WATER/GAS-TIGHT SEAL AND HAVE H-20 RATED CAPACITY.

EXCAVATION

1. SURROUNDING SOIL MUST BE UNDISTURBED SOIL OR WELL COMPACTED ENGINEERING FILL.
2. WIDTH AND LENGTH OF EXCAVATION SHALL BE MINIMUM 150mm GREATER THAN THE TANK ON ALL SIDES.
3. DEPTH OF EXCAVATION SHALL BE 150mm DEEPER THAN TANK BOTTOM.

OIL INTERCEPTOR INSTALLATION

1. CANNOT BE INSTALLED FLUSH WITH FLOOR. RISER MUST BE USED FOR BELOW GRADE INSTALLATIONS WITH A MINIMUM BURIAL DEPTH OF 100mm.
2. ENSURE THE UNIT COVER IS LEVEL WITH FINISHED GRADE.
3. FILL WITH WATER BEFORE BACKFILLING TO STABILIZE THE UNIT AND PREVENT FLOAT OUT DURING BACKFILLING.

BACKFILLING & FINISHED CONCRETE SLAB

1. BEFORE BACKFILLING AND POURING OF SLAB, SECURE COVER AND RISER TO THE UNIT.
2. PLACE 150mm AGGREGATE BASE UNDER SLAB. AGGREGATE SHOULD BE 19mm SIZE ROCK, OR SAND, WITH NO FINES.
3. BACKFILL USING CRUSHED AGGREGATE MATERIAL APPROXIMATELY 19mm SIZE ROCK, OR SAND, WITH NO FINES.
4. 15M REBAR GRADE 60 STEEL PER ASTM A615: CONNECTED WITH TIE WIRE.
5. REBAR TO BE 63mm FROM EDGE OF CONCRETE.

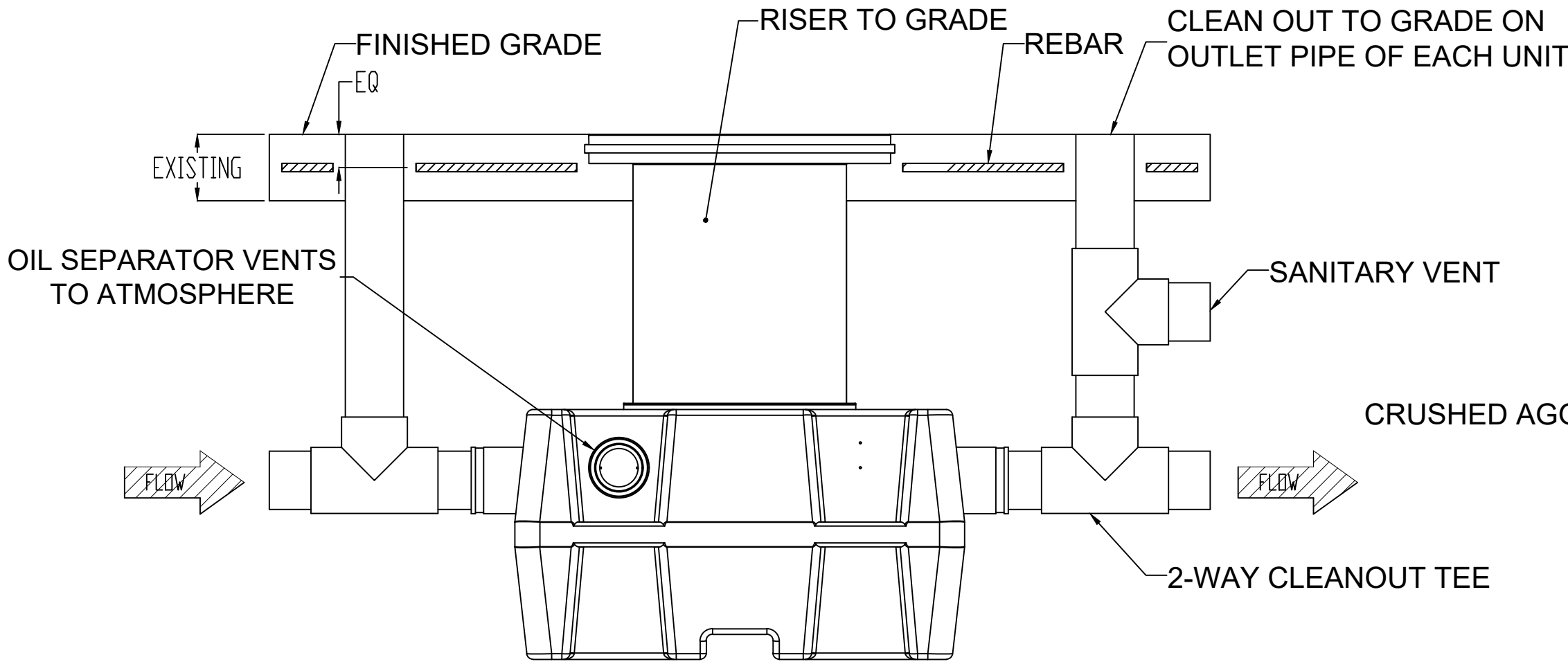

OIL INTERCEPTOR DETAIL
SCALE: NTS

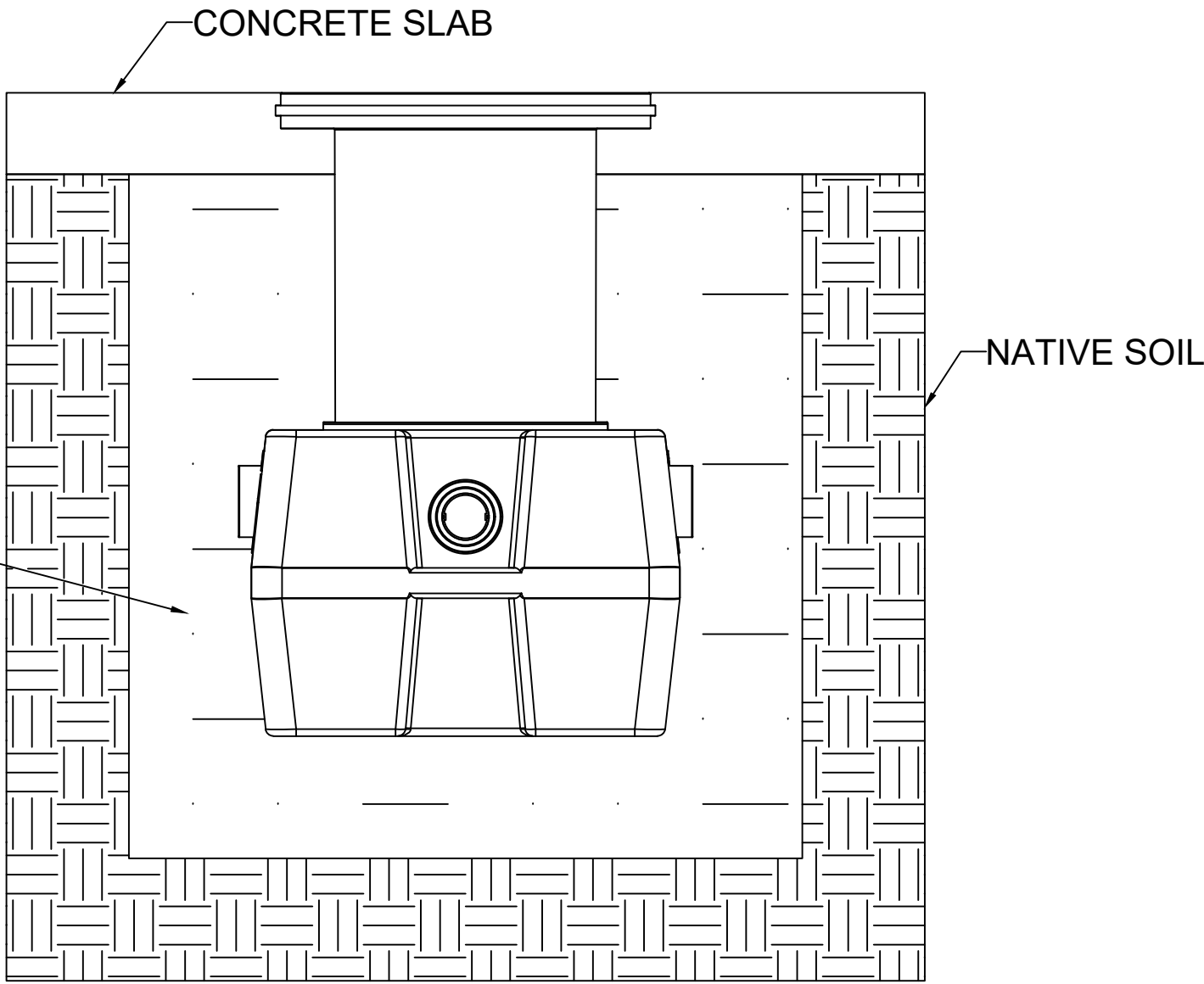

CLIENT LOGO

KEYPLAN (NTS)



DISCLAIMER NOTES

1. THE CONTRACTOR SHALL BE SOLELY RESPONSIBLE FOR ISSUES/PROBLEMS WHICH MAY OCCUR AS A RESULT OF A FAILURE TO FOLLOW THESE PLANS, SPECIFICATIONS AND THE DESIGN INTENT THEY CONVEY.
2. WHERE THERE ARE ALLEGED ERRORS, OMISSIONS, INCONSISTENCIES OR AMBIGUITIES PRESENT IN THE CONTRACT DOCUMENTS, THE CONTRACTOR MUST SEEK CLARIFICATION FROM JP2G. ANY COSTS OR SCHEDULE DELAYS WHICH RESULT AS A FAILURE TO CONTACT JP2G FOR DIRECTION SHALL BE SOLELY THE RESPONSIBILITY OF THE CONTRACTOR.
3. DO NOT SCALE DRAWINGS. REFER ANY DIMENSIONAL CLARIFICATIONS AND/OR POSSIBLE TRADE INTERFERENCE/CONFLICTS TO JP2G FOR CLARIFICATION PRIOR TO COMMENCEMENT OF THE WORK.
4. THE CONTRACTOR SHALL BE RESPONSIBLE FOR ALL COORDINATION WITH SUBTRADES AND SHALL ADDRESS CONSTRUCTION TEAM COORDINATION ITEMS PRIOR TO ISSUING REQUESTS FOR INFORMATION FROM JP2G.
5. THE POSITION OF POLE LINES, CONDUITS, WATERMANS, SEWERS AND OTHER UNDERGROUND AND OVERGROUND UTILITIES AND STRUCTURES IS NOT NECESSARILY SHOWN ON THE CONTRACT DRAWING, AND, WHERE SHOWN, THE ACCURACY OF THE POSITION OF SUCH UTILITIES AND STRUCTURES IS NOT GUARANTEED. BEFORE STARTING WORK, THE CONTRACTOR SHALL INFORM THEMSELVES OF THE EXACT LOCATION OF ALL SUCH UTILITIES AND STRUCTURES, AND SHALL ASSUME ALL LIABILITY FOR DAMAGE TO THEM.

NOT FOR
CONSTRUCTION

1 2025-04-29 KH ISSUED FOR TENDER

No. YYYY-MM-DD BY DESCRIPTION

STAMP



PROJECT

PITTSTON - GARAGE
GRIT OIL SEPARATOR
REPLACEMENT

4145 County Rd 22,
Spencerville ON K0E 1X0

DRAWING

DETAILS

GREER GALLOWAY
a division of **JP2g Consultants Inc.**
640 CATARAUGUI WOODS DR, UNIT 2A, KINGSTON, ON, K7P 2Y5
T: 613-536-5420
KINGSTON@JP2G.COM

JP2g PROJECT No.: 2455470

NORTH

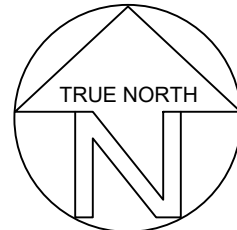

CLIENT No.: XXXX

DRAFTED: M. ROWSELL

DESIGNED: A. HICKS

REVIEWED: K. HAWLEY

APPROVED: K. HAWLEY

SCALE

1:250
0 m 2 4 6 8 10 m

H=

1:250

V=

1:50

SHEET #

C-3